

MATCH LINE - SEE SHEET C01.51.4 FOR CONTINUATION

MATCH LINE - SEE BOTTOM LEFT SHEET FOR CONTINUATION

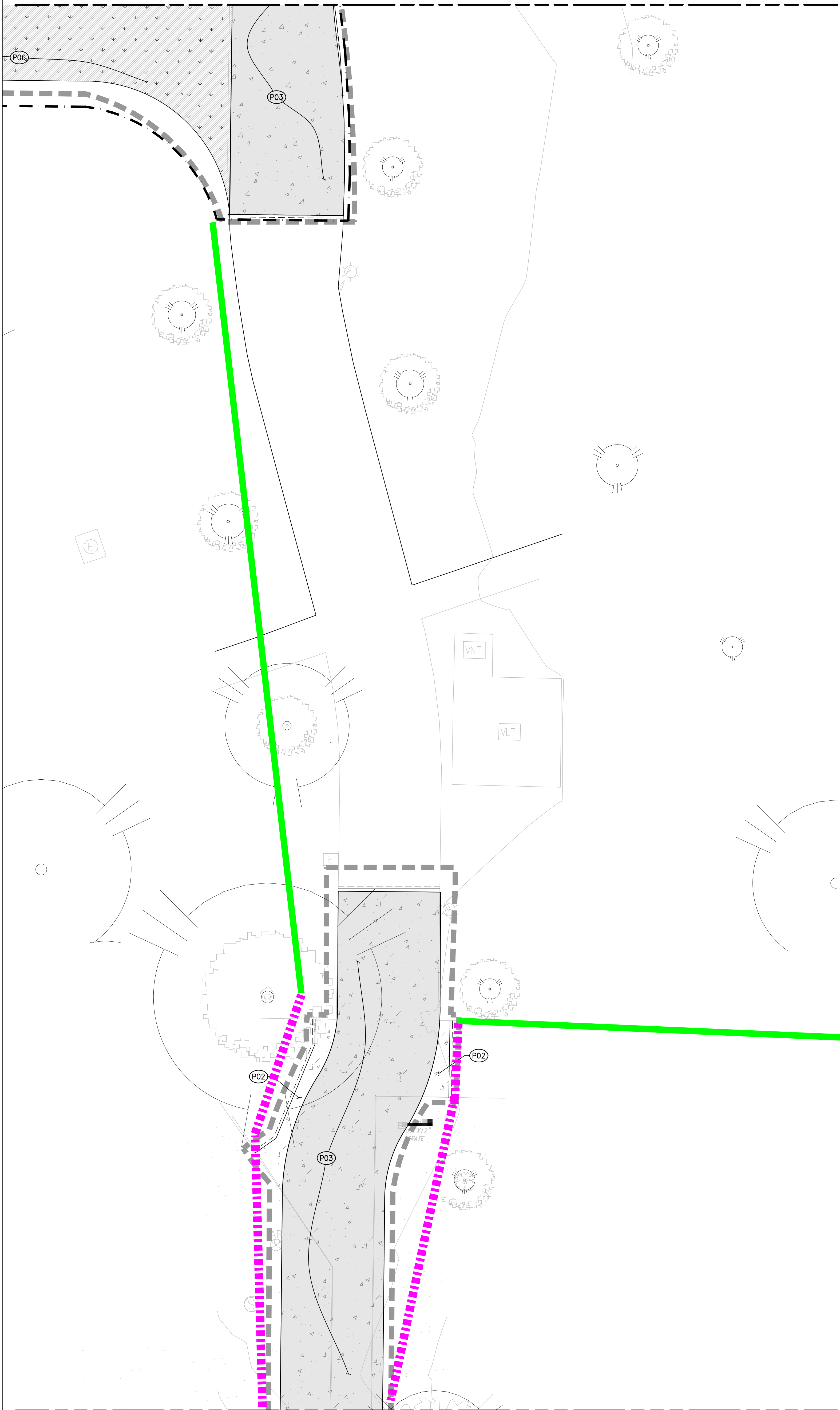

MATCH LINE - SEE UPPER RIGHT SHEET FOR CONTINUATION

PAVING CONSTRUCTION NOTES

- (P01) CURB OPENING PER DETAIL 1, SHEET C01.60.
- (P02) PEDESTRIAN CONCRETE PAVEMENT PER DETAIL 2 ON SHEET C01.60.
- (P03) VEHICULAR CONCRETE PAVEMENT PER DETAIL 2 ON SHEET C01.60.
- (P04) THICKENED EDGE PER DETAIL 6 ON SHEET C01.60.
- (P05) CONCRETE STAIRS. SEE ARCHITECTURAL PLANS FOR DETAILS.
- (P06) GRASSPAVE. SEE LANDSCAPE PLANS FOR DETAILS.
- (P07) CONCRETE CURB. PER DETAIL 5, SHEET C01.60.
- (P08) PLANTER WALL. REFER TO LANDSCAPE AND STRUCTURAL PLANS FOR DETAILS.
- (P09) ASPHALT PAVEMENT PER DETAIL 12 ON SHEET C01.60.
- (P10) CONCRETE STAIRS ON GRADE PER DETAIL 13 ON SHEET C01.60.

LEGEND

- LIMIT OF WORK
- - - PROPERTY LINE
- [Pattern] VEHICULAR CONCRETE PAVING (REFER TO SHEET C01.60.4 FOR DETAILS)
- [Pattern] PEDESTRIAN CONCRETE PAVING (REFER TO SHEET C01.60.4 FOR DETAILS)
- [Pattern] PLANTER AREA/LANDSCAPE (REFER TO LANDSCAPING PLANS FOR DETAILS)
- [Pattern] GRASSPAVE (REFER TO LANDSCAPING PLANS FOR DETAILS)
- [Pattern] PROPOSED BUILDING (REFER TO ARCHITECTURAL PLANS FOR DETAILS)
- [Pattern] BIOFILTRATION PLANTER (REFER TO LANDSCAPING PLAN FOR DETAILS)
- [Pattern] ASPHALT PAVING (REFER TO SHEET C01.60 FOR DETAILS)

Legend

- [Solid Green Line] Existing Fence Line
- [Dashed Magenta Line] South Road Fence Line

NOTE TO CONTRACTOR/CONSTRUCTION SURVEYOR:
 CONSTRUCTION STAKING FOR IMPROVEMENTS SHOWN ON THESE PLANS SHALL BE PERFORMED BY A LICENSED LAND SURVEYOR. CONSTRUCTION STAKING SURVEYOR SHALL BE RESPONSIBLE FOR COORDINATION OF THESE PLANS WITH SOURCE DRAWINGS PREPARED BY ARCHITECT, LANDSCAPE ARCHITECT, STRUCTURAL ENGINEER, MEP CONSULTANT AND ANY OTHER DISCIPLINE PRIOR TO START OF STAKING AND CONSTRUCTION. ANY DISCREPANCIES THAT OCCUR SHALL BE BROUGHT TO THE ATTENTION OF THE ARCHITECT PRIOR TO THE START OF CONSTRUCTION SO THAT A CLARIFICATION CAN BE ISSUED.

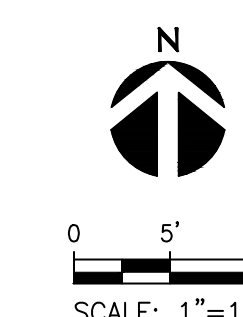

900 University Ave
 Riverside, CA 92521

Gensler

500 South Figueroa Street
 Los Angeles, California 90071
 United States
 Tel 213.327.3600
 Fax 213.327.3601



700 South Flower Street
 Suite 2100
 Los Angeles, CA 90017
 O: 213.418.0201
 F: 213.266.5294
 www.kpff.com

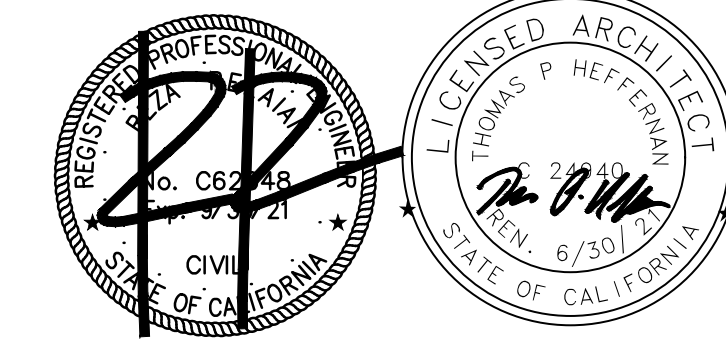

Seal / Signature

Date	Description
10/31/2019	PKG 4 100% DD
03/06/2020	PKG 4 ISSUE FOR PERMIT
04/27/2020	S&F - ISSUE FOR PERMIT
06/19/2020	S&F - ISSUE FOR PERMIT FOR BACKCHECK

ISSUE FOR PERMIT FOR BACKCHECK

SHELL AND FINISH

Project No: 950512 SSC
 CAAN#: P5823

Project Name
 UCR Student Success Center

Project Number
 950512

Description
 HORIZONTAL CONTROL AND PAVING PLAN

Scale
 1" = 10'

C01.52